

[from Stations]

#### From Shinagawa Station

5 minutes by Free Shuttle Bus from both JR & Keikyū Line Shinagawa Station, Takanawa Exit or 10 minutes walk to the hotel.

#### From Kita-Shinagawa Station

Approximately 5 minutes walk from Keikyū Line Kita-Shinagawa Station.

[from Airports]

#### From Haneda Airport

Approximately 30 minutes by Airport Limousine Bus or 20 minutes by Keikyū Line.

#### From Narita Airport

Approximately 100 minutes by Airport Limousine Bus.

### TOKYO MARRIOTT HOTEL

4-7-36 Kitashinagawa,  
Shinagawa-ku, Tokyo 140-0001 Japan  
T: +81.3.5488.3911

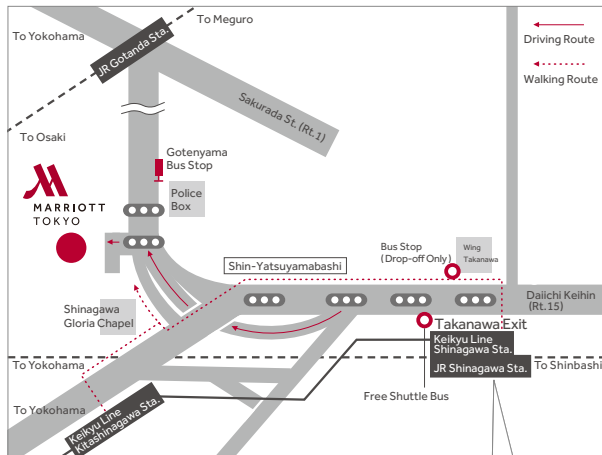

- (A) Free Shuttle Bus  
Stops at a little ahead of  
the bus stop of Minato Ward  
Community Bus "Chii-Bus" No.159
- (B) Free Shuttle Bus  
(Drop-Off Only)



## Free Shuttle Bus

Shinagawa Station  
↓  
Tokyo Marriott Hotel

	Weekdays	Sat, Sun, PH
8	15 35 55	35 55
9 ∫ 20	15 35 55	
21	15	

Tokyo Marriott Hotel  
↓  
Shinagawa Station

	Weekdays	Sat, Sun, PH
8	00 20 40	20 40
9 ∫ 20	00 20 40	
21	00 20	